

# Adelaide Aquatic Centre Development

City of Adelaide Update

13 June 2023

# Status update

---

- Concept design progressing
- Project update by Premier, Minister for Infrastructure and Transport, Treasurer 11 June 2023
  - Concept design images released
  - Increased project budget
  - Existing centre to close August 2024
  - Sports vouchers announced
  - Procurement for the project builder commenced
- Post project announcement activities (on Saturday, as well as over the new few weeks)
  - Contact made with key stakeholders including key user groups, pool operators and other key stakeholders
  - Project website updated, social media posts and email sent to people who have registered for updates
  - Pop-up in Adelaide Aquatic Centre lobby staffed at key times since Saturday afternoon
  - Barton Terrace West residents door knocked
  - Letterbox drop to occur this week to local residents
  - Community Information Sessions planned for 22 June and 24 June 2023

# Concept Design

Preliminary Entry View



Artist's Impression

# Concept Design

## Preliminary Entry View



Artist's Impression

# Concept Design

## Preliminary Entry View



# Concept Design

Preliminary Entry View



# Key scope items

---

- The new centre will include:
  - 50m, 10-lane indoor pool suitable for carnivals, sport and recreational use
  - a 25m, six-lane outdoor pool with lagoon
  - a dedicated warm-water indoor pool incorporating a rehabilitation program
  - a dedicated indoor pool for learn-to-swim programs
  - diving amenities
  - extensive indoor and outdoor all-ages play areas with waterslides, splash zones, BBQs and lawned areas
  - café available for both centre visitors and other Park 2 users
  - gym and fitness facilities three times larger than previously planned
  - spa, sauna and steam room
  - community change rooms
  - improved car parking with access from Jeffcott Road, improved public transport, pedestrian and cycle pathways connecting the centre with existing networks

# Facility size – existing vs new

Key Metrics	Current	New
Building height	19.5m high point of roof	17.5m water slide tower 12m two storey section 7m southern side (lower in some sections)
Building footprint / area	11,360 sqm	9,500 sqm
Car Park area	8,600 sqm (266 carparks)	12,500 sqm (375 carparks)
External areas (forecourt, public realm, etc)	10,345 sqm	7,305 sqm
<b>Total project site area</b>	<b>30,305 sqm [Note 1]</b>	<b>29,305 sqm</b>

[Note 1] The area was surveyed by a licensed surveyor. The area included the existing centre and carpark and all the areas within.



# Return to Park Lands zone

Return to Park Lands Working Group established with Council officers

Integration of Return to Park Lands scope into project Master Plan includes:

- 70m set back from Barton Terrace West kerb
- Park Land Trail and connections maintained
- Recreational sporting oval capable of a range of uses
- Improved movement networks (park trails, pathways and service access roads)
- Tree planting and green canopy landscape strategy
- Grass area to south of the centre



# Development Area

## Adelaide Aquatic Centre Development Area

Development Area - AACD and Return to Park Lands Zone  
(after Demolition of Existing Centre)

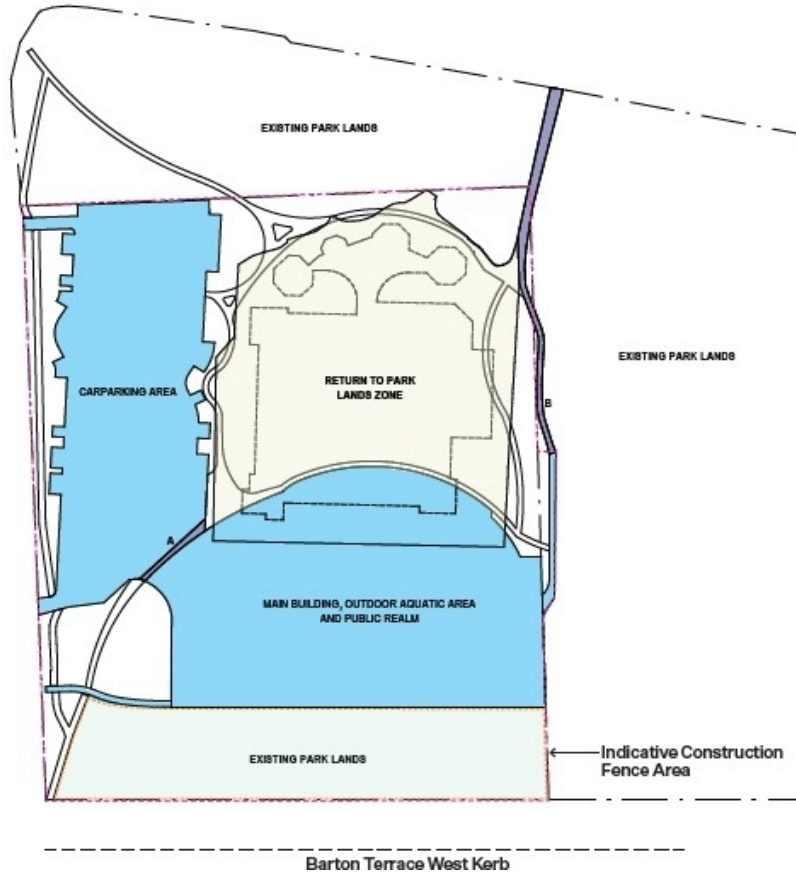

- Area in blue is the proposed area for the Adelaide Aquatic Centre Development
- Area in light green is the Return to Park Land Zone for the purpose of determining the design and funding with the CoA
- Up until August 2024 when the existing centre closes, access will be maintained to the existing centre carpark and existing aquatic centre during this time

# Next Steps

---

## Next Steps

- Execution of the Project Agreement with CoA
  - Targeting end June 2023
- Further analysis of users of the existing facility and alternative aquatic facilities
  - Being led by Office of Recreation, Sport and Racing
  - Expanding on the preliminary work completed to date
- Progressing to lodge with SCAP mid July 2023
  - Public consultation process as part of SCAP
- Builder engaged October 2023
- Planned commencement on-site, subject to SCAP approval, October 2023
  - Site establishment including maintaining access to the existing centre, relocation of site services within the new centre footprint, site preparation and establishment works etc